

GBD

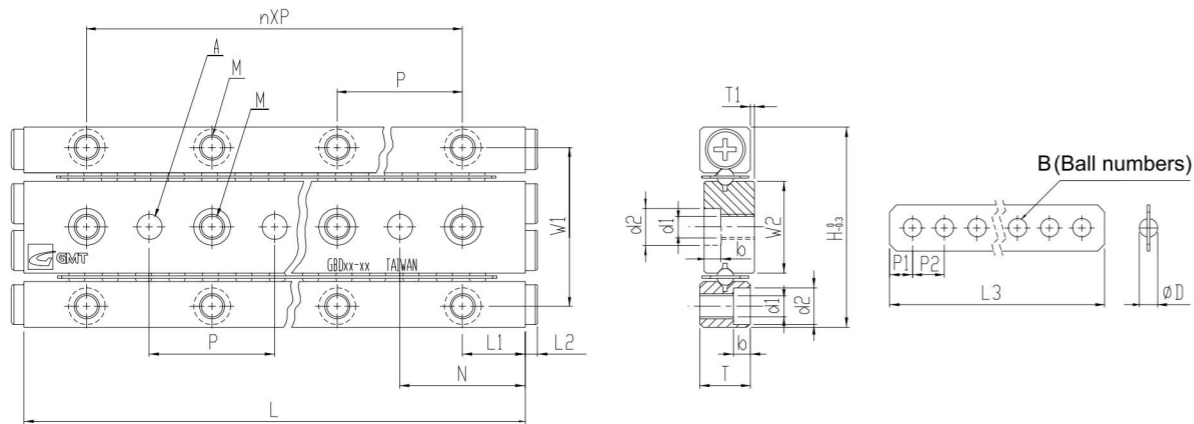

Specification

Model No.	Max. Stroke (mm)	Main Dimensions (mm)									Retainer Dimensions (mm)					
		H	T	L	n*p	W1	W2	L1	L2	N	ØD	L3	B	P1	P2	T1
GBD01-20	13	17	4	20	1*10	13.4	7.8	5	1.3	10	Ø1.5	15.5	5	1.75	3	0.5
GBD01-30	21			30	2*10							21.5	7			
GBD01-40	29			40	3*10							27.5	9			
GBD01-50	37			50	4*10							33.5	11			
GBD01-60	45			60	5*10							39.5	13			
GBD01-70	53			70	6*10							45.5	15			
GBD01-80	61			80	7*10							51.5	17			
GBD02-30	24	24	6	30	1*15	19	11	7.5	1.5	15	Ø2	20.6	5	2.3	4	0.5
GBD02-45	30			45	2*15							32.6	8			
GBD02-60	44			60	3*15							40.6	10			
GBD02-75	58			75	4*15							48.6	12			
GBD02-90	72			90	5*15							56.6	14			
GBD02-105	86			105	6*15							64.6	16			
GBD02-120	100			120	7*15							72.6	18			
GBD02-135	106			135	8*15							84.6	21			
GBD02-150	120			150	9*15							92.6	23			
GBD02-165	134			165	10*15							100.6	25			
GBD02-180	148			180	11*15							108.6	27			

Ordering Example :	GB	D	01	40	P
	Ball	D rail	Ball dia.	Rail length	Precision Level

GBD



Material Specification

Material Component	Rail	Ball Bearing	Retainer
Model No.			
GBD	SUJ2		Phosphor bronze (C5191)

Mounting Dimensions (mm)					Load Per Ball Bearing			Weight (g) / 2 Pieces
M	d1	d2	A	B	Basic Dynamic Load Rating	Basic Static Load Rating	Allowable Load	Standard
M2	1.65	3	2 ^{+0.010} ₀	1.4	7.6N/1pcs	21N/1pcs	7.0N/1pcs	9
								13
								16
								20
								24
								28
M3	2.55	4.4	3 ^{+0.010} ₀	2	12N/1pcs	37N/1pcs	12.3N/1pcs	33
								27
								40
								53
								66
								78
								91
								104
								117
129								
142								
155								

GBD

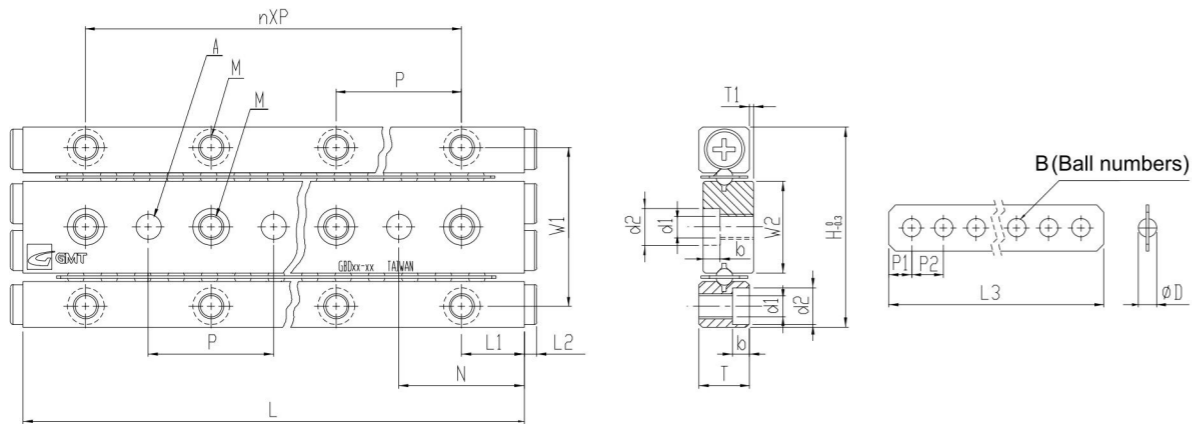

Specification

Model No.	Max. Stroke (mm)	Main Dimensions (mm)									Retainer Dimensions (mm)					
		H	T	L	n*p	W1	W2	L1	L2	N	ØD	L3	B	P1	P2	T1
GBD03-50	34	36	8	50	1*25	29	16.6	12.5	2	25	Ø3	35.7	7	2.86	5	0.5
GBD03-75	54			75	2*25							50.7	10			
GBD03-100	74			100	3*25							65.7	13			
GBD03-125	104			125	4*25							75.7	15			
GBD03-150	124			150	5*25							90.7	18			
GBD03-175	144			175	6*25							105.7	21			
GBD03-200	164			200	7*25							120.7	24			
GBD03-225	184			225	8*25							135.7	27			
GBD03-250	204			250	9*25							150.7	30			
GBD03-275	224			275	10*25							165.7	33			
GBD03-300	244			300	11*25							180.7	36			
GBD04-80	54	44	11	80	1*40	35	20	20	2	40	Ø4	56.8	8	3.9	7	0.5
GBD04-120	92			120	2*40							77.8	11			
GBD04-160	130			160	3*40							98.8	14			
GBD04-200	154			200	4*40							126.8	18			
GBD04-240	192			240	5*40							147.8	21			
GBD04-280	230			280	6*40							168.8	24			
GBD04-320	254			320	7*40							196.8	28			
GBD04-360	292			360	8*40							217.8	31			
GBD04-400	330			400	9*40							238.8	34			
GBD04-440	354			440	10*40							266.8	38			
GBD04-480	392			480	11*40							287.8	41			

Ordering Example :

GB	D	03	75	P
Ball	D rail	Ball dia.	Rail length	Precision Level

GBD



Material Specification

Material Component	Rail	Ball Bearing	Retainer
Model No.			
GBD		SUJ2	Phosphor bronze (C5191)

Mounting Dimensions (mm)					Load Per Ball Bearing			Weight (g) / 2 Pieces
M	d1	d2	A	b	Basic Dynamic Load Rating	Basic Static Load Rating	Allowable Load	Standard
M4	3.3	6	4 ^{+0.012} ₀	3.1	26.5N/1pcs	84N/1pcs	28N/1pcs	94
								139
								183
								228
								272
								317
								361
								406
								450
								495
								539
M5	4.3	7.5	5 ^{+0.012} ₀	4.1	43N/1pcs	148N/1pcs	49.3N/1pcs	247
								365
								483
								601
								720
								838
								957
								1076
								1194
								1314
								1432