

Specification

Model No.			Max. Stroke (mm)	Roller Dia. (mm)	Main Dimensions (mm)				Table Mounting Dimensions (mm)				External Connection Moution Dimensions (mm)									
Standard	Antirust	Black Coating			W	T	T ₂	L	W ₁	M	Q	N*P	W ₃	W ₄	W ₅	W ₆	M ₁	W ₂	d ₁	d ₂	h ₁	T ₁
GRM30-25	GRM30-25-N	GRM30-25-B	12				25			/												
GRM30-35	GRM30-35-N	GRM30-35-B	18				35			1*10												
GRM30-45	GRM30-45-N	GRM30-45-B	25				45			2*10												
GRM30-55	GRM30-55-N	GRM30-55-B	32	Ø1.5	30 _{±0.03}	17±0.1	11	55	10	M2*4L	12.5	3*10	12	/	2.5	/	M2*6L	22	2.5	4.5	2.5	5.5
GRM30-65	GRM30-65-N	GRM30-65-B	40				65			4*10												
GRM30-75	GRM30-75-N	GRM30-75-B	45				75			5*10												
GRM30-85	GRM30-85-N	GRM30-85-B	50				85			6*10												
GRM40-35	GRM40-35-N	GRM40-35-B	18				35			/												
GRM40-50	GRM40-50-N	GRM40-50-B	30				50			1*15												
GRM40-65	GRM40-65-N	GRM40-65-B	40				65			2*15												
GRM40-80	GRM40-80-N	GRM40-80-B	50				80			3*15												
GRM40-95	GRM40-95-N	GRM40-95-B	60				95			4*15												
GRM40-110	GRM40-110-N	GRM40-110-B	70	Ø2.0	40 _{±0.03}	21±0.1	14	110	15	M3*6L	17.5	5*15	16	/	3.4	/	M2*6L	30	3.5	6.5	3.5	6.5
GRM40-125	GRM40-125-N	GRM40-125-B	80				125			6*15												
GRM40-140	GRM40-140-N	GRM40-140-B	90				140			7*15												
GRM40-155	GRM40-155-N	GRM40-155-B	100				155			8*15												
GRM40-170	GRM40-170-N	GRM40-170-B	110				170			9*15												
GRM40-185	GRM40-185-N	GRM40-185-B	120				185			10*15												
GRM60-55	GRM60-55-N	GRM60-55-B	30				55			/												
GRM60-80	GRM60-80-N	GRM60-80-B	45				80			1*25												
GRM60-105	GRM60-105-N	GRM60-105-B	60				105			2*25												
GRM60-130	GRM60-130-N	GRM60-130-B	75				130			3*25												
GRM60-155	GRM60-155-N	GRM60-155-B	90				155			4*25												
GRM60-180	GRM60-180-N	GRM60-180-B	105	Ø3.0	60±0.1	28±0.1	18.5	180	25	M4*8L	27.5	5*25	40	/	5.5	/	M3*6L	40	4.5	8	4.5	9
GRM60-205	GRM60-205-N	GRM60-205-B	130				205			6*25												
GRM60-230	GRM60-230-N	GRM60-230-B	155				230			7*25												
GRM60-255	GRM60-255-N	GRM60-255-B	180				255			8*25												
GRM60-280	GRM60-280-N	GRM60-280-B	205				280			9*25												
GRM60-305	GRM60-305-N	GRM60-305-B	230				305			10*25												

Ordering Example : GRM - 30 - 25 - N
 M type table - Table width - Table length - Antirust



Material Specification

Material / Component / Model No.	Table	Rail	Retainer	Roller
GRM	Aluminum alloy +black anodized	SUJ2	SUS304	SUJ2
GRM - N	S50C+Ni	SUJ2+Ni	SUS304	SUJ2
GRM - B	S50C +phosphate	SUJ2	SUS304	SUJ2

GRM-N No Surface finished to V-groove surface of the rail.

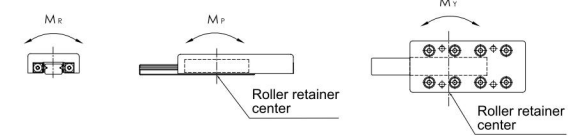

★ Each of load and torque changes oppositely in stroke variation

Base Mounting Dimensions (mm)							Basic Dynamic Load Rating C(N)	Basic Static Load Rating Co(N)	Allow-Able Load Fu(N)	Static Rated Moment			Weight (kg)		Table Moving Accuracy (µm)	
h ₂	L ₁	L ₂	L ₃	L ₄	L ₅	L ₇				M _R (N·m)	M _P (N·m)	M _V (N·m)	Standard	Antirust	Center Parallelism	Side Parallelism
9	3.5	18					379	576	192	2.6	1.2	1.4	0.04	0.09	2	4
		28		/			523	865	288	3.9	2.6	3.0	0.05	0.12		
		38					657	1,153	384	5.2	4.6	5.2	0.07	0.16		
		48	/	28	/	/	/	783	1,441	480	6.5	7.2	7.9	0.08		
		58		38				903	1,729	576	7.8	10.4	11.2	0.10	0.23	
		68		48				1,131	2,306	769	10.4	18.4	17.3	0.12	0.27	
		78		58				1,240	2,594	865	11.7	23.3	22.0	0.13	0.30	
10.9	5	25					895	1,170	390	7.0	3.1	3.9	0.09	0.20	2	4
		40		/			1,552	2,339	780	14.0	12.5	10.9	0.13	0.29		
		55					1,849	2,924	975	17.5	19.5	17.5	0.17	0.38		
		70		40		/	2,134	3,509	1,170	21.1	28.1	30.4	0.21	0.46		
		85		55			2,407	4,093	1,364	24.6	38.2	40.9	0.25	0.55		
		100	/	70	/		2,930	5,263	1,754	31.6	63.2	59.6	0.30	0.64		
		115		85		/	3,181	5,848	1,949	35.1	78.0	74.1	0.34	0.73		
		130		100		70	3,427	6,433	2,144	38.6	94.3	98.6	0.38	0.82		
		145		115		85	3,668	7,017	2,339	42.1	112.3	117.0	0.42	0.91		
		160		130		100	4,136	8,187	2,729	49.1	152.8	147.4	0.46	1.00		
175		145		115	4,365	8,772	2,924	52.6	175.4	169.6	0.50	1.08				
15	10	35					2,901	4,567	1,522	42.6	22.8	26.6	0.29	0.66	2	5
		60		/			4,338	7,611	2,537	71.0	63.4	57.1	0.43	0.96		
		85					5,646	10,655	3,552	99.5	124.3	115.4	0.57	1.26		
		110		/			6,268	12,178	4,059	113.7	162.4	172.5	0.71	1.57		
		135	85				7,462	15,222	5,074	142.1	253.7	266.4	0.84	1.87		
		160	110		/	/	8,603	18,266	6,089	170.5	365.3	350.1	0.98	2.17		
		185	135	85			9,157	19,789	6,596	184.7	428.8	445.2	1.12	2.47		
		210	160	110			9,702	21,311	7,104	198.9	497.3	515.0	1.25	2.77		
		235	185	135			10,767	24,355	8,118	227.3	649.5	629.2	1.39	3.07		
		260	210	160	110		11,288	25,877	8,626	241.5	733.2	711.6	1.53	3.37		
		285	235	185	135		11,802	27,400	9,133	255.7	822.0	844.8	1.66	3.68		

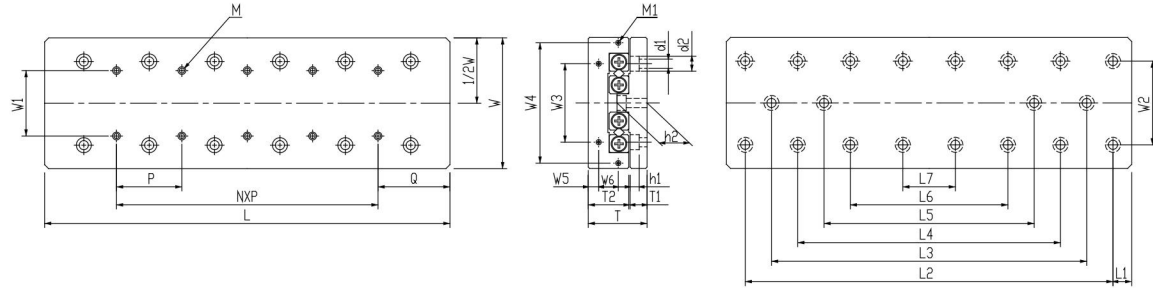

Specification

Model No.			Max. Stroke (mm)	Roller Dia. (mm)	Main Dimensions (mm)				Table Mounting Dimensions (mm)			External Connection Mounting Dimensions (mm)										
Standard	Antirust	Black Coating			W	T	T ₂	L	W ₁	M	Q	N*P	W ₃	W ₄	W ₅	W ₆	M ₁	W ₂	d ₁	d ₂	h ₁	T ₁
GRM80-85	GRM80-85-N	GRM80-85-B	50				85			/												
GRM80-125	GRM80-125-N	GRM80-125-B	75				125			1*40												
GRM80-165	GRM80-165-N	GRM80-165-B	105				165			2*40												
GRM80-205	GRM80-205-N	GRM80-205-B	130				205			3*40												
GRM80-245	GRM80-245-N	GRM80-245-B	155	4.0	80±0.1	35±0.1	24	245	40	M5*10L	42.5	4*40	55	/	6.5	/	M3*6L	55	5.5	10	5.4	10.5
GRM80-285	GRM80-285-N	GRM80-285-B	185				285			5*40												
GRM80-325	GRM80-325-N	GRM80-325-B	210				325			6*40												
GRM80-365	GRM80-365-N	GRM80-365-B	235				365			7*40												
GRM80-405	GRM80-405-N	GRM80-405-B	265				405			8*40												
GRM100-110	GRM100-110-N	GRM100-110-B	60				110			/												
GRM100-160	GRM100-160-N	GRM100-160-B	95				160			1*50												
GRM100-210	GRM100-210-N	GRM100-210-B	130				210			2*50												
GRM100-260	GRM100-260-N	GRM100-260-B	165				260			3*50												
GRM100-310	GRM100-310-N	GRM100-310-B	200	6.0	100±0.1	45±0.1	31	310	50	M6*12L	55	4*50	60	92	8	15	M4*8L	60	7	11.5	7	13
GRM100-360	GRM100-360-N	GRM100-360-B	235				360			5*50												
GRM100-410	GRM100-410-N	GRM100-410-B	265				410			6*50												
GRM100-460	GRM100-460-N	GRM100-460-B	300				460			7*50												
GRM100-510	GRM100-510-N	GRM100-510-B	335				510			8*50												

Ordering Example :	GRM	30	25	N
	M type table	Table width	Table length	Antirust



Material Specification

Component / Material / Model No.	Table	Rail	Retainer	Roller
GRM	Aluminum alloy +black anodized	SUJ2	SUS304	SUJ2
GRM - N	S50C+Ni	SUJ2+Ni	SUS304	SUJ2
GRM - B	S50C +phosphate	SUJ2	SUS304	SUJ2

GRM-N No Surface finished to V-groove surface of the rail.

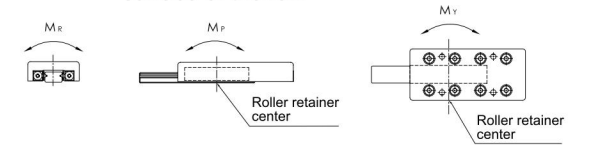

★ Each of load and torque changes oppositely in stroke variation

Base Mounting Dimensions (mm)							Basic Dynamic Load Rating C(N)	Basic Static Load Rating Co(N)	Allow-Able Load Fu(N)	Static Rated Moment			Weight (kg)		Table Moving Accuracy (µm)		
h ₂	L ₁	L ₂	L ₃	L ₄	L ₅	L ₇				M _R (N·m)	M _P (N·m)	M _V (N·m)	Standard	Antirust	Center Parallelism	Side Parallelism	
10.5	10.5	65					6,617	9,357	3,119	124.8	87.3	76.4	0.76	1.69	2	5	
		105	/				9,097	14,035	4,678	187.1	196.5	180.1	1.12	2.50	3	6	
		145		/			10,264	16,375	5,458	218.3	267.5	286.6	1.48	3.31			
		185	105	/			12,492	21,053	7,018	280.7	442.1	466.7	1.84	4.11			
		225	145		/	/	/	14,612	25,732	8,577	343.1	660.4	690.5	2.20	4.91	4	7
		265	185				16,646	30,410	10,137	405.5	922.4	957.9	2.56	5.72			
		305	225	145			18,612	35,089	11,696	467.8	1228.1	1269.0	2.92	6.51			
		345	265	185			20,519	39,767	13,256	530.2	1577.4	1623.8	3.28	7.32			
		385	305	225			22,377	44,445	14,815	592.6	1970.4	1918.6	3.65	8.13	4	8	
		90	/				13,923	21,053	7,018	315.8	252.6	221.1	1.60	3.48			3
140		/			16,592	26,316	8,772	394.7	394.7	434.2	2.36	5.10					
190	90	/			21,596	36,842	12,281	552.6	773.7	828.9	3.11	6.70	4	7			
240	140		/	/	26,285	47,369	15,790	710.5	1279.0	1207.9	3.86	8.32					
290	190			/	30,744	57,895	19,298	868.4	1910.5	1823.7	4.62	9.94					
340	240	140		/	35,024	68,421	22,807	1026.3	2688.4	2565.8	5.36	11.53			4	8	
390	290	190			39,160	78,948	26,316	1184.2	3552.6	3434.2	6.12	13.15					
440	340	240			41,181	84,211	28,070	1263.2	4042.1	4168.4	6.87	14.76					
490	390	290	190		45,141	94,737	31,579	1421.1	5115.8	5257.9	7.62	16.36					