

VL series

Caratteristiche

Materiale Corpo:

Phenoplasto rinforzato di colore Nero, resistente a solventi, oli, grassi ed altri agenti chimici

Parte Metallica e/o

Fissaggio:

Mozzo in AVP zincato con pre-foro

Product specification

Main Part Material:

Black Phenoplast, solvents, oils, greases and other chemical agents proof

Metallic Part Material &

Finishing:

Zinc Plated Steel Hub with Predrilled Hole



Volantino a 4 Razze Handwheel, 4-Spokes

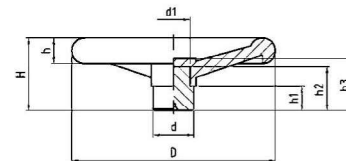

Codice	D	d	d1	H	h	h1	h2	h3	Peso grammi Weight gr	Confezione Pz Packing Pcs.
B1VL100	100	24	21	47	15	17	36	39	189	1
B1VL120	120	25	21	49	16	15	35	38	219	1
B1VL140	140	28	23	54	20	17	38	41	331	1
B1VL160	160	32	27	56	22	21	40	43	450	1
B1VL200	200	40	32	72	25	25	47	51	773	1
B1VL250	250	50	42	82	29	29	56	60	1505	1
B1VL300	300	52	42	95	35	30	63	68	2120	1

VLA series

Caratteristiche

Materiale Corpo:

Phenoplasto rinforzato di colore Nero, resistente a solventi, oli, grassi ed altri agenti chimici

Parte Metallica e/o

Fissaggio:

Mozzo in AVP zincato con preforo per esecuz.foro passante

Product specification

Main Part Material:

Black Phenoplast, solvents, oils, greases and other chemical agents proof

Metallic Part Material &

Finishing:

Zinc plated Steel Visible Hub, with preformed Punching



Volantino a 4 Razze e con Mozzo Affiorante Handwheel, 4-Spokes, Visible Hub

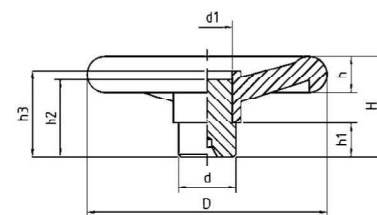

Codice	D	d	d1	H	h	h1	h2	h3	Peso grammi Weight gr	Confezione Pz Packing Pcs.
B1VLA100	100	24	21	47	15	17	36	39	207	1
B1VLA120	120	25	21	49	16	15	35	38	231	1
B1VLA140	140	28	23	54	20	17	38	41	345	1
B1VLA160	160	32	27	56	22	21	40	43	473	1
B1VLA200	200	40	32	72	25	25	47	51	815	1
B1VLA250	250	50	42	82	29	29	56	60	1559	1
B1VLA300	300	52	42	95	35	30	63	68	2173	1