

SIŁA TRZYMANIA / HOLDING FORCE - F = 300 kg

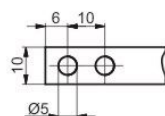

NACISKACZ / CLAMPING ARM

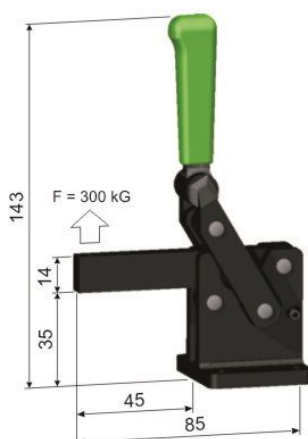
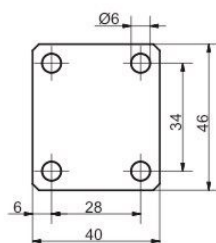

PODSTAWA / BASE

WAGA / WEIGHT - 0,46 kg

SIŁA TRZYMANIA / HOLDING FORCE - F = 700 kg

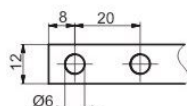
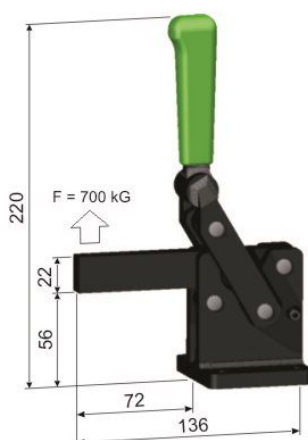

NACISKACZ / CLAMPING ARM

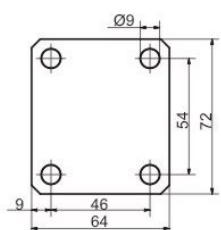

PODSTAWA / BASE

WAGA / WEIGHT - 1,50 kg

SIŁA TRZYMANIA / HOLDING FORCE - F = 1200 kg

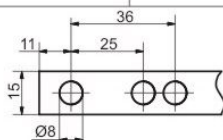
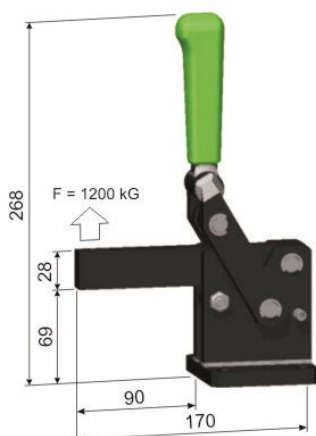

NACISKACZ / CLAMPING ARM

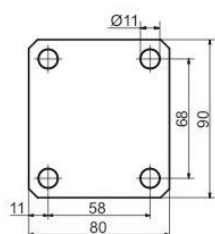

PODSTAWA / BASE

WAGA / WEIGHT - 2,92 kg

SIŁA TRZYMANIA / HOLDING FORCE - F = 2300 kg

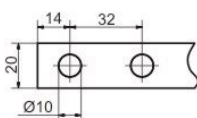
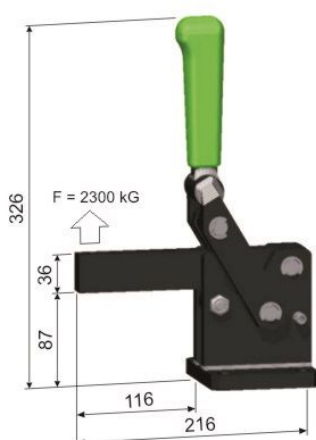

NACISKACZ / CLAMPING ARM

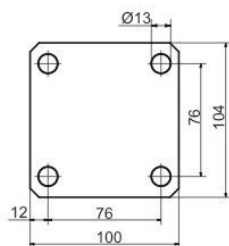

PODSTAWA / BASE

WAGA / WEIGHT - 5,80 kg